

Process Technology

Multifunctional Process Controller with analogue outputs



Multifunction Process Controller Type 573

The process controller with 2 analogue inputs can be used both in single channel mode as well as in dual channel. In dual channel mode, all arithmetic operations are

available for displaying sum total, difference, ratio or the product. Inputs and outputs can be scaled separately.

AC/DC 17... 260 V	 DIN 48 x 96	 IP 65	 Menu-driven programming	 Operation with gloves	 2 Inputs	 6 LEDs	 Tare-Function-Output	 Output	 2 Transistor-Output
-----------------------------	-----------------	-----------	-----------------------------	---------------------------	--------------	------------	--------------------------	------------	-------------------------

Innovative:

- 2 separate freely scalable analogue inputs +/-10 V, 0 ...10 V and 0/4 ... 20 mA, Resolution 14 bit
- Tare function – the unit can be set to 0 for any input voltage
- Programmable linearization: with up to 16 control points, input via key-pad or via the Teach-In function
- Averaging measurement over 2 to 16 measuring cycles, for use with serious fluctuations of the input signals
- Easy to programme - the desired display value is simply keyed-in for a specific input signal
- Fast 25 ms sampling rate per channel alternating



Compact:

- Up to 3 display values in one device, display A, display B + display calculated based on A and B
- AC and DC supply voltages in one device
- Simple menu-driven programming with just 2 keys, as well as Tare or Teach-In key

Versatile:

- Can be used as a simple process signal converter, process controller (ON/OFF controller) or for complex measuring tasks where the relationship between two values, one to the other, must be monitored, calculated or further processed in a higher-level controller.
- Mathematical operation of the measured values of inputs A and B. The result can also if required be multiplied, divided or added to an offset value, in order to obtain the desired display value.
- Analogue output 0/4 ... 20 mA, +/-10 V or 0 ... 10 V
- 2 fast PNP switching outputs, 50 ms, with switching hysteresis, step or tracking preset
- Programmable display refresh time

Application examples:

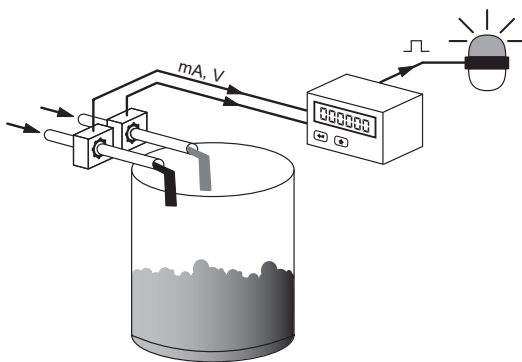

Monitoring of mixing ratios and display of flow rate

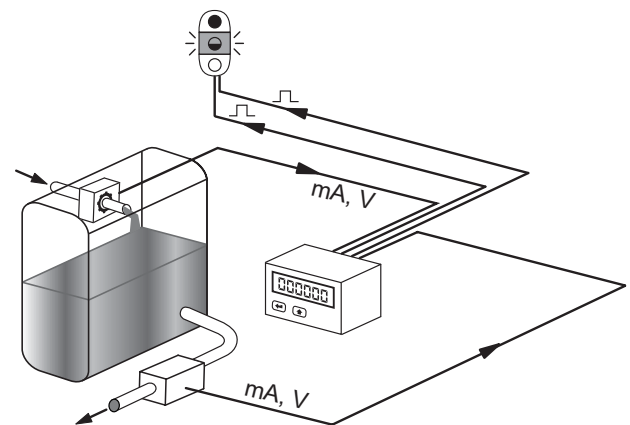

Level monitoring and adjustment, display of inflow and outflow

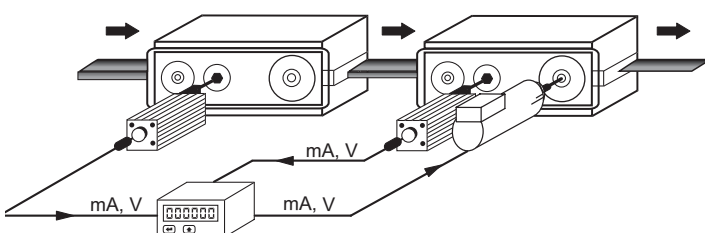

Material stretching, as well as monitoring of synchronous operation, with display of individual speeds

Process Technology

Multifunction Process Controller with analogue outputs

Multifunction Process Controller Type 573

Supply-voltage:	17 ... 30 V DC (Nominal voltage: 24 V DC)	Analogue output	0 ... 20 mA, 4 ... 20 mA (max. 300 Ohm)
Power consumption [DC]:	115/230 V AC \pm 12.5 %		-10 ... +10 V, 0 ... 10 V (max. 2 mA)
Connected load [AC]:	18 V: 110 mA, 24 V: 90 mA		Response time max. 57 ms (analogue output)
Auxiliary power supply output for sensors:	30 V: 80 mA		7 ms after detection of the measurement value)
Display:	7,5 VA	Resolution:	14 Bit (13 Bit + sign)
Inputs:	24 V DC \pm 15%, 100 mA (at AC and DC supply)	Operating temperature:	0 ... +45 °C
Input resistance:	15 mm high LED display, 6 Digits	Storage temperature:	-25 ... +70 °C
Measuring time per channel:	2 analogue inputs (\pm 10 V, 0 ... 20 mA, 4 ... 20 mA)	Housing:	Noryl UL94-V-0
Resolution:	Current: Ri = 100 Ohm, Voltage Ri = 30 kOhm	Protection:	IP 65 front, IP20 rear
Accuracy:	25 ms (alternating)	Connections:	Signal max. 1.5 mm ² , AC supply max. 2.5 mm ²
Outputs:	14 Bit (13 Bit + sign)	EMC:	CE conform to EC directive 89/336/EWG
Switching outputs:	\pm 0.1% \pm 1 digit	Standards:	EN 61 000-6-2/EN 61 000-6-3
2 x PNP, max. 35 V, max. 150 mA		Weight:	NS73/23/EWG: EN 61010-1
Response time max. 50 ms			approx. 200 g

Dimensions:

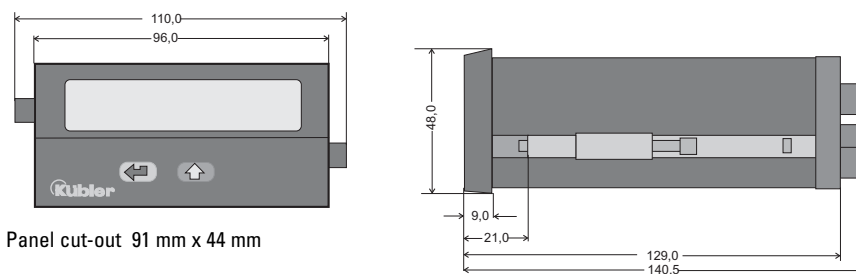

Panel cut-out 91 mm x 44 mm

Terminal assignment: with analogue output

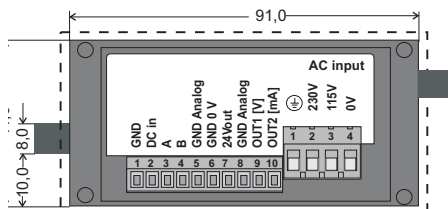

with 2 outputs

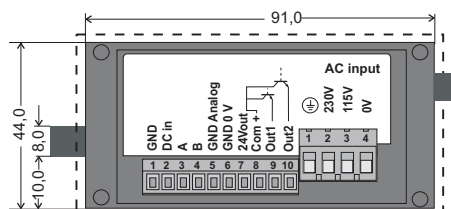

Connection example:

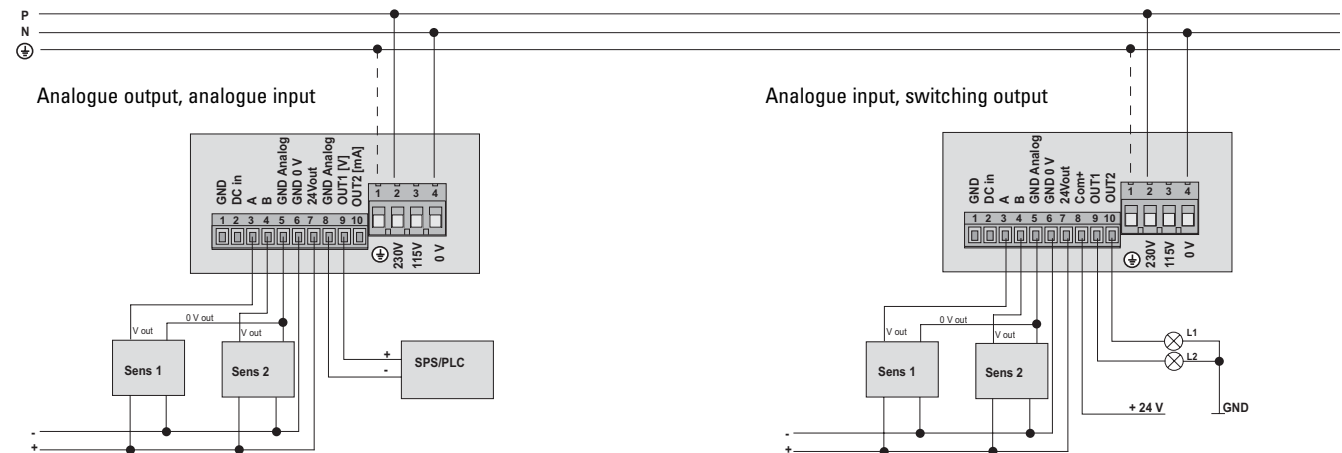

Delivery includes:

- Process Controller 573
- Gasket
- Mounting set
- Multilingual operating instructions, German /English

Order codes:

- Display with 2 outputs Order code 6.573.011.E00
- Display with analogue output Order code 6.573.012.E90