

Bevel Gearboxes

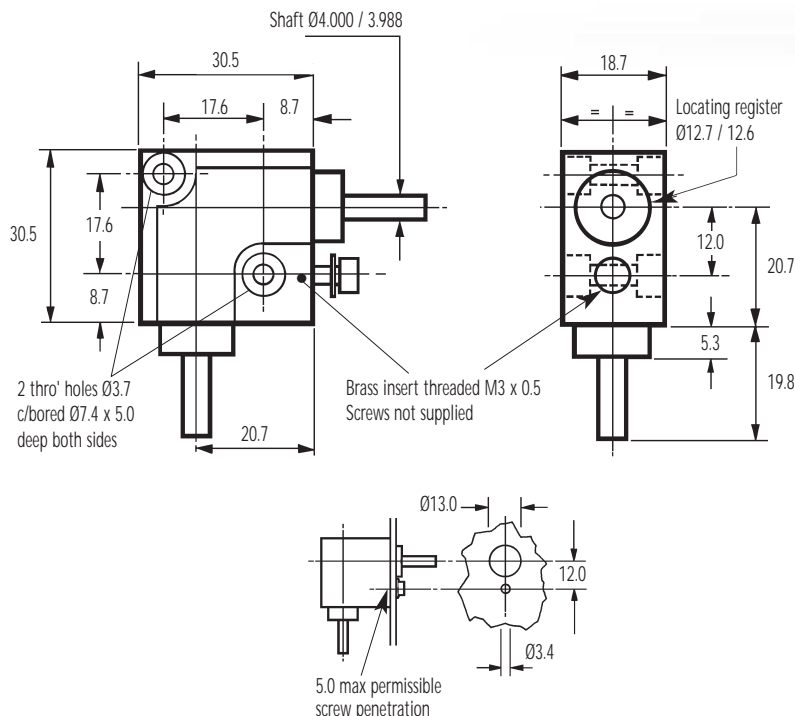

Huco L-Box



HUCO L-BOX REF. 332.31.2

Hardened steel gears bonded to ground and hardened steel shafts. Sintered bronze bearing system. Gearbox and bearings lubricated for life.

Electrical isolation between shafts and housing.

Suitable for manual, and short term drive applications.

Max torque 0.68 Nm.

Mass 41 g.

HUCO L-BOX REF. 333.31.3

Acetal gears moulded onto ground and hardened steel shafts. Sintered bronze bearing system. Gearbox and bearings lubricated for life.

Electrical isolation between input/output shafts and between shafts and housing.

Suitable for manual, and short term drive applications.

Max torque 0.11 Nm.



Mass 37 g.

54

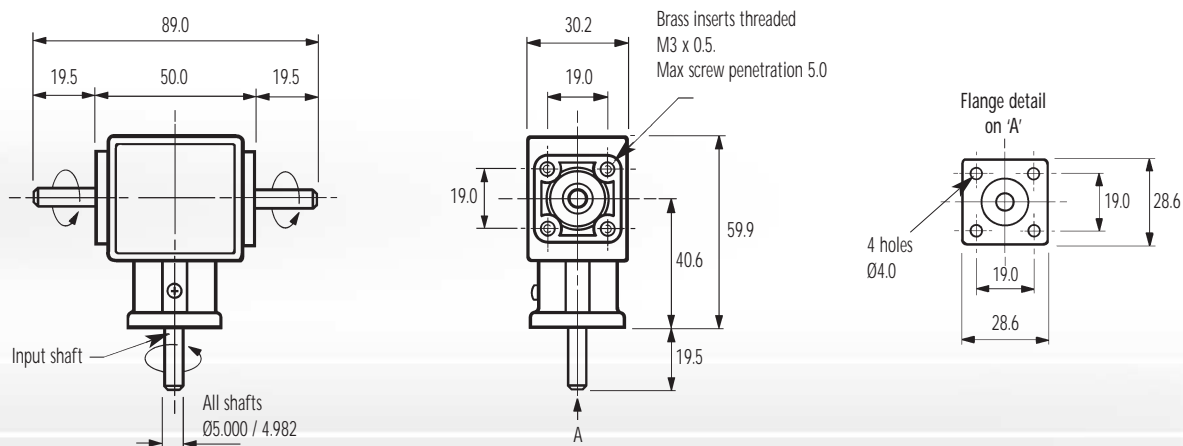
Huco T-Box



Alternative face mounting available (not shown). Please enquire for details

Configuration	Total nr. of shafts	Max input speed	Max power kW	Max backlash	Output torque Nm	Ratio	Mass g	T-Box ref.
	3	1500 rpm	0.053	2°	0.34	1:1	115	335.50.11
					0.68	2:1	130	335.50.12
	2				0.34	1:1	115	336.50.11
					0.68	2:1	130	336.50.12
	2				0.34	1:1	115	337.50.11
					0.68	2:1	130	337.50.12

To adapt shafts for larger bores, specify Huco-Lok adaptor 253.20 for Ø6.35 bores or 254.20 for Ø8 bores.

CAUTION

Gears may bind if gearbox is dropped on either of its shafts. Avoid endwise blows to shafts.