

Contrast Sensors BKT 67M

... for fast and reliable print mark detection



more added value



Contrast Sensors BKT 67M

Specially designed for print mark detection

BALLUFF
sensors worldwide



- Three models for any application complexity
- Reliable color mark detection with red, green or blue light emission
- Rugged aluminum housing
- Greatest freedom in equipment design with selectable front or bottom light exit

- Simple device for detecting all standard contrast marks
- Easy, fast startup
- Optimal price/performance ratio
- 20 KHz switching frequency for controlling fast packaging processes
- Manual adjustment for compensating contrast tolerances
- Four LED's and bar graph display for monitoring the sensor settings
- 30 kHz switching frequency for controlling the fastest packaging processes
- Can be calibrated on-the-fly
- 4-digit display for setting up complex contrast relationships

		Basic	Advanced	Premium
Working distance	9 mm (with standard lens)	■	■	■
Light type	Red-Green-Blue	■	■	■
Light spot size	1.5 x 5 mm	■	■	■
Switching frequency	15 kHz	■		
	20 kHz		■	
	30 kHz			■
Calibration	Auto	■		
	Auto/manual/remote		■	
	Auto/manual/remote/dynamic			■
Display	2 LED's	■		
	5-segment bar display		■	
	4-digit display			■
Switching output	PNP/NPN selectable	■	■	■
Output logic	Light-on/dark-on selectable	■	■	■
Analog output	0...5.5 V (3 V on 90 % white)	■	■	■
Time functions	20 ms programmable	■	■	
	0...100 ms programmable			■
Connection	M12x1/5-pin	■	■	■
Lens material	PMMA	■		
	Glass		■	■
Housing material	Aluminum	■	■	■
Other	Key disable	■	■	■
	Switching hysteresis configurable			■

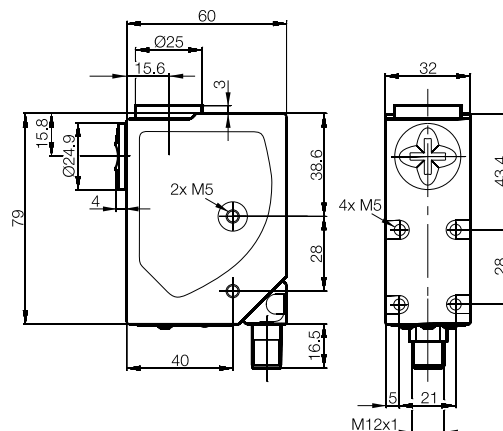

Ordering example:

BKT 67M- -U-S92

- 001** Basic, vertical light spot
- 002** Basic, horizontal light spot
- 003** Advanced, vertical light spot
- 004** Advanced, horizontal light spot
- 005** Premium, vertical light spot
- 006** Premium, horizontal light spot



Balluff GmbH
Schurwaldstrasse 9
73765 Neuhausen a.d.F.
Germany
Phone +49 7158 173-0
Fax +49 7158 5010
balluff@balluff.de
■ www.balluff.com