

# BALLUFF

## **BAW High-pressure Inductive Distance Sensor**

... continuous position sensing for hydraulic actuators



Housing size	M12x1
Mounting	flush
Output signal $U_o$	voltage 0...10 V
Linear range $s_l$	0.5...2 mm

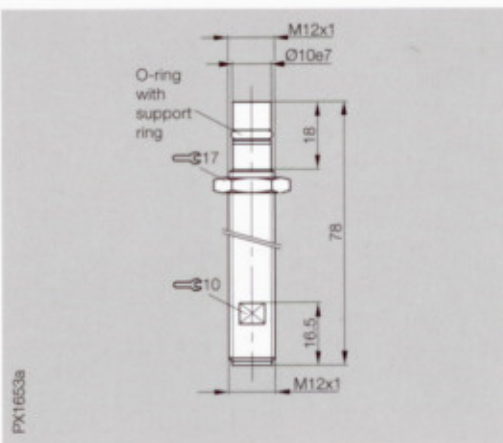
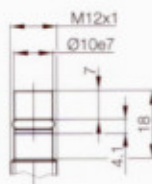

**The new BAW high-pressure rated inductive sensor with analog interface.**

Detects short excursions on hydraulic actuators (e. g. valves and cylinders).

### Applications

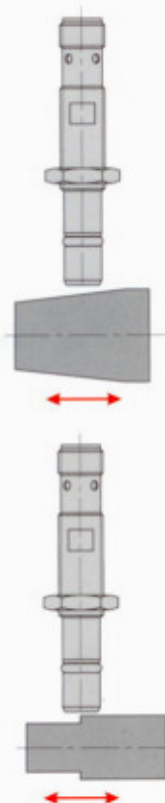

Ordering code	BAW M1215
Rated operational voltage $U_o$	24 V DC
Supply voltage $U_B$	15...30 V DC
Ripple	$\leq 15\%$ of $U_o$
Rated insulation voltage $U_i$	75 V DC
Rated sensing distance $s_o$	1.25 mm
Load resistance $R_L$	$\geq 2\text{ k}\Omega$
No-load supply current $I_o$ at $U_o$	$\leq 8\text{ mA}$
Protected against polarity reversal	yes
Short circuit protected	yes
Ambient temperature range $T_a$	-25...+90 °C
Degree of protection per IEC 60529	IP 68 per BWN Pr. 20
Housing material	stainless steel
Material of sensing face	ceramic
Connection	connector
Recommended connector	BKS-B 19/B 20-1-PU2
O-ring/replacement part number	7x2/123170
Support ring/replacement part number	10x7x1/134196
High pressure rated up to	500 bar

### Wiring diagram



### Approach curve

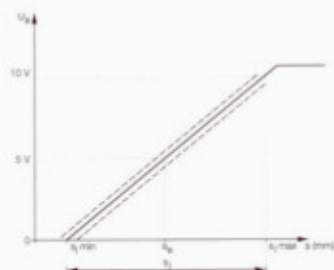

BALLUFF SLOVAKIA s.r.o.  
Jána Bottu 4  
974 01 Banská Bystrica  
tel.: 048-472 34 11, 60, 61, 62  
fax: 048-472 3469  
Mobil: 0905-056 393, 0907 345 989  
e-mail: sekretariat@balluff.sk  
www.balluff.sk